



# Landscaping Guidelines



## **Pertaining to Stages 1-6 Brookvale Subdivision, Lincoln**

Landscaping on private lots assists in developing the overall neighbourhood character, defines the transition between private and public space, softens the visual appearance of the built form, offers shade in summer and allows sunshine to enter during winter, provides privacy and improves the visual appearance and amenity of the property.

The landscaping of your property should consider privacy and protection whilst providing a link between indoor and outdoor living areas. The landscaping will also have to contribute to the overall streetscape appeal.

All open spaces need to be landscaped by trees, hedges, shrubs, grass and other forms of landscape such as paving and decking.

At least 1 feature tree shall be provided per lot with the species to be selected from the planting palette provided. If an alternative species is proposed, this must have Developer Approval.

In the case of a corner lot, at least 1 feature tree shall be provided along every road boundary frontage.

A Landscape Plan must be completed for the entire site and submitted for Developer Approval. This plan must include the following, upon application;

- Hard landscape: driveway, paths, patio or decks, with specification of finished surfaces.
- Fencing: style, transparency, height and colour
- Service area: bins, clothesline
- Garden shed: style, height and colour
- Letterbox: design and colour
- Soft landscape: grass and planting, schedule of plant species to be provided
- Specimen tree: species name

A palette of suggested plant species can be found on the next page.



**FEATURE TREES**

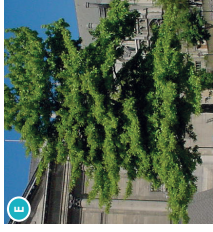

Pin Oak  
(*Quercus palustris*)



Kowhai  
(*Sophora microphylla*)



Magnolia 'Blanchard'  
(*Magnolia grandiflora*)



Red maple  
(*Acer rubrum*)

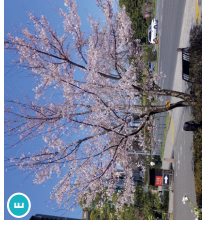

Yoshino cherry  
(*Prunus yedoensis*)

# Plant Palette

**SHRUBS / GRASSES / GROUNDCOVERS**



Miniature toetoe  
(*Chionochloa flavicans*)



Mexican orange blossom  
(*Choisya ternata*)



Wharwhara  
(*Asteria banksii*)



Emerald gem hebe  
(*Hebe 'Emerald Gem'*)

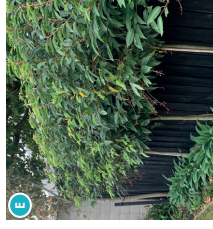

Portuguese laurel  
(*Prunus lusitanica*)

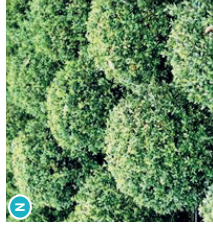

'Midget' and 'LimeLight'  
(*Pittosporum 'Midget'*  
and '*LimeLight'*)

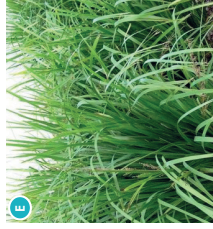

Lomandra  
(*Lomandra tanika*)



Chilean guava  
(*Ugni molinae*)



NZ Iris  
(*Liberia peregrinans*)

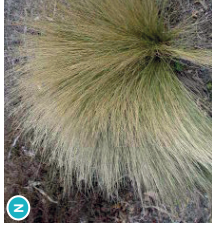

Silver tussock  
(*Poa cita*)



Groundcover coprosma  
(*Coprosma acerosa 'Hawera'*)



Liriopse  
(*Liriopse muscari 'Royal Purple'*)



NZ Daphne  
(*Pimelea prostrata*)

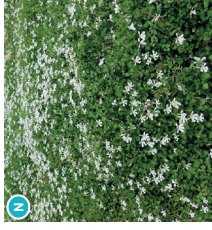

Panakenake  
(*Pratia angulata*)

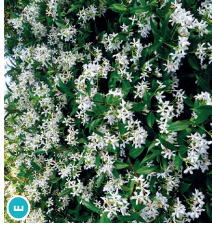

Star Jasmine  
(*Trachelospermum jasminoides*)

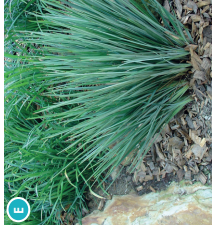

Tasmanian Flax-Lily  
(*Dianella 'Little Rev'*)



Shrubby torararo  
(*Muehlenbeckia astonii*)



Pohuehue  
(*Muehlenbeckia axillaris*)



Turutu  
(*Dianella nigra*)

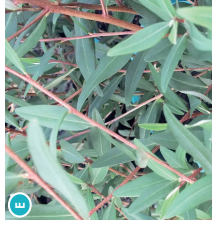

Satin wood  
(*Phebalium squameum*)



Black mondo grass  
(*Ophiopogon planiscapus 'Black Dragon'*)



Box hedging  
(*Buxus sempervirens*)



Lemonwood  
(*Pittosporum eugenioloides*)



Broadleaf Kapuka  
(*Griselinia littoralis*)



Josh Allan  
Telephone: 027 901 7889  
Email: [groundcontroldesignnz@gmail.com](mailto:groundcontroldesignnz@gmail.com)



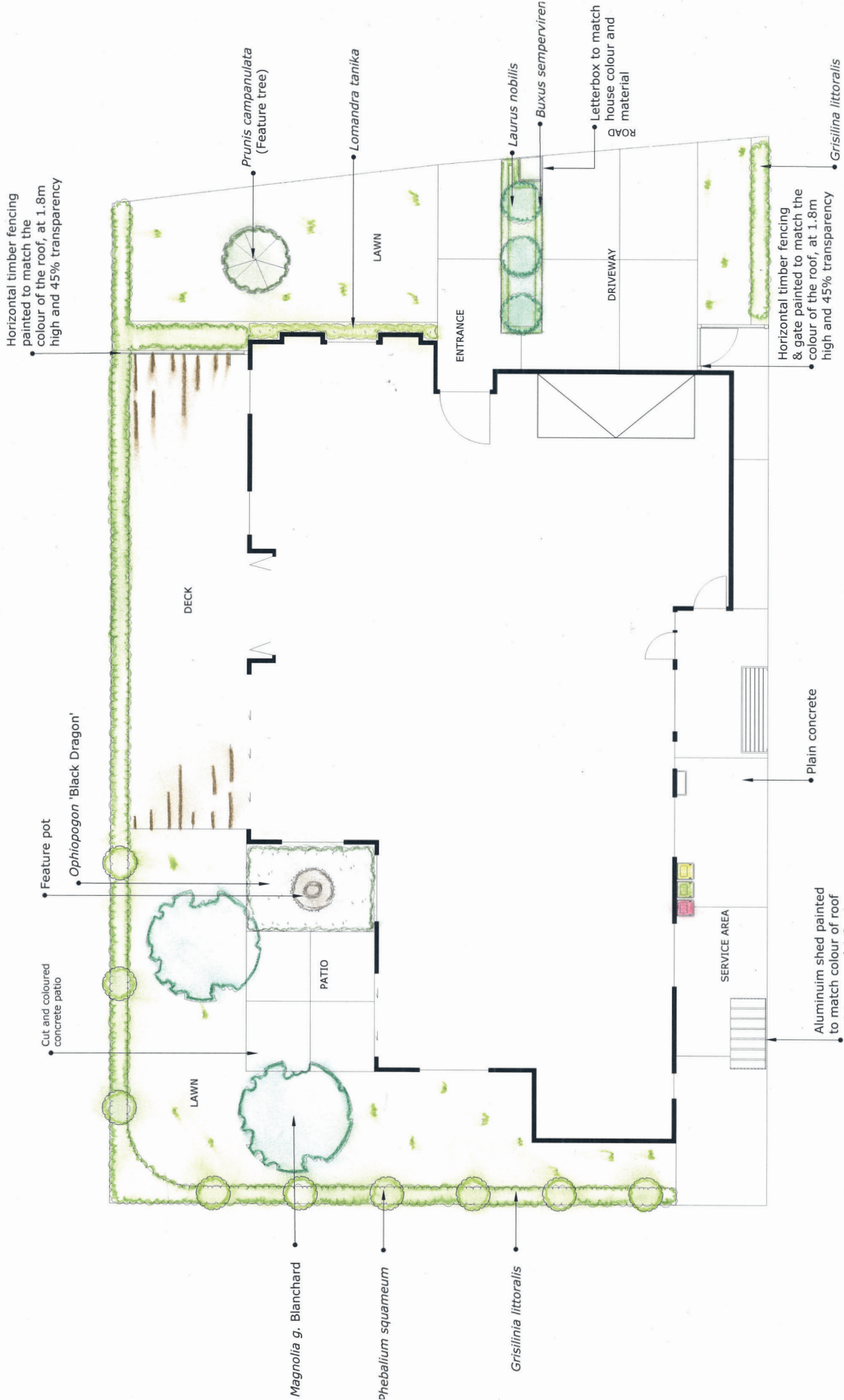

PLAN: S3 LGE-V3  
SCALE: 1:100 @ A3

# Landscape Guideline Example Silverstream

Designer: Josh Allan  
Phone: 027 901 7889  
Email: groundcontroldesignnz@gmail.com

